

POLYGON

OWNER MANUAL





HELIOS / A



HELIOS A0 AXS



HELIOS / A



HELIOS A9



HELIOS / A



HELIOS A8



HELIOS / A



HELIOS A7

CONGRATULATIONS!

Congratulations for buying Polygon Bikes! A bicycle is a great tool for transportation and recreation. Hopefully, you can find enjoyment and have a great deal of use in every ride. This manual contains important information which includes safety, performance, and maintenance.

IMPORTANT

Read this manual before taking your first ride and use it for future reference as well.

Additional safety, performance, and service information related to specific components such as suspension, pedals, and other accessories, such as helmets or lights you have purchased. Make sure your nearest authorized dealer has given all the manufacturing literature which includes in your bicycle and accessories. In case of conflict between the instructions and information provided in this manual, always follow the component manufacturer's instructions.

If you have any questions or do not understand something within this guide, take responsibility for your safety and consult with your nearest authorized dealer or the bicycle's manufacturer.

NOTE

This manual is not intended for comprehensive use, service repair, or service manual. Please see your nearest authorized dealer for all service, repairs, and maintenance-related action. Your dealer is also able to refer you to classes, clinics, or books for service or maintenance.

WARNING

To ensure the warranty of your bicycle, be sure to only use the original spare parts.

HELIOS A
TABLE OF CONTENT

01	INTRODUCTION	07	SEATPOST CUTTING INSTRUCTION
02	TABLE OF CONTENT	10	REGULAR INSPECTION
03	EXPLODED VIEW	11	HOW TO CLEAN THE BIKE
04	FRAME KITS	12	HOW TO CLEAN THE BIKE'S
05	CABLE ROUTING		CHAIN
06	GROUPSET PARTS		

HELIOS A
EXPLODED VIEW

LF VIEW

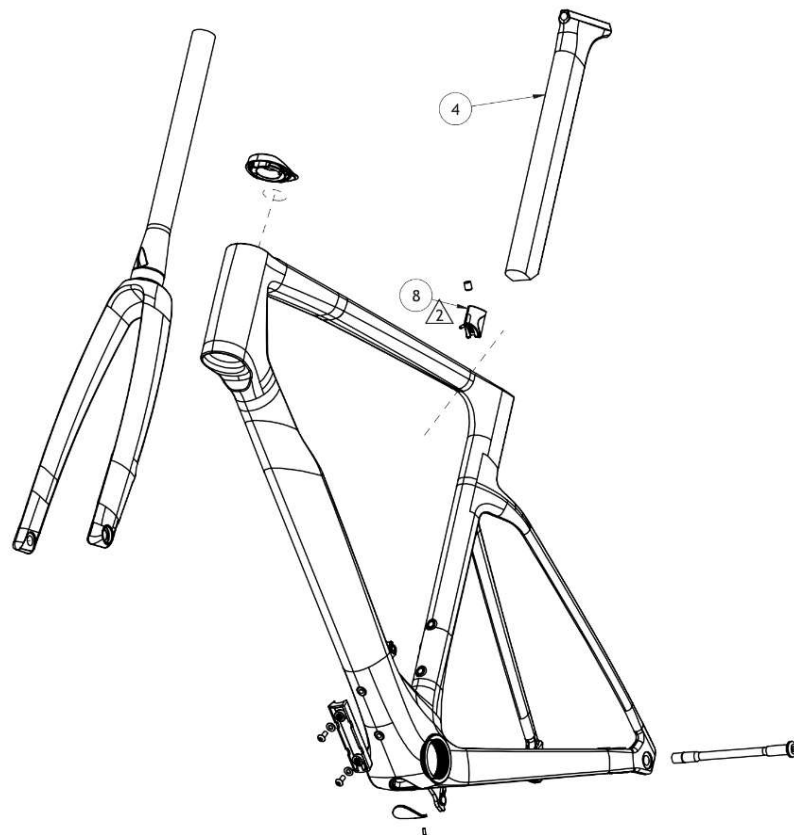

RR VIEW

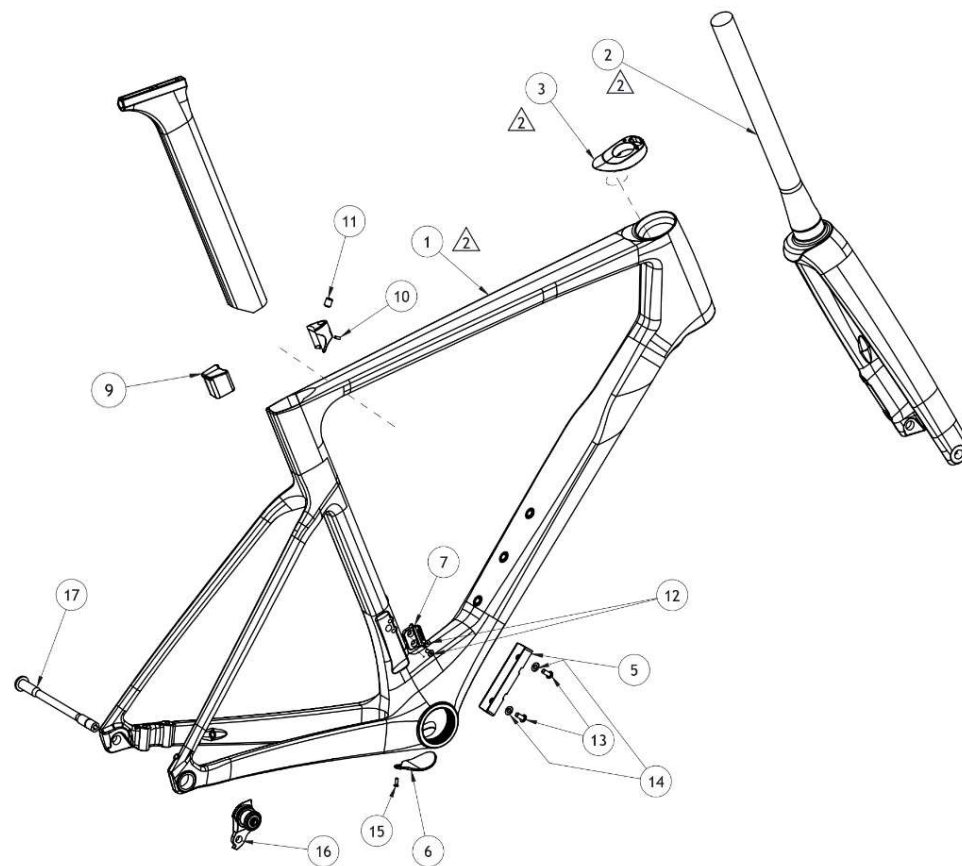

HELIOS A FRAME KITS

PART	ARTICLE	ITEM	ITEM DETAILS	TORQUE (N.m)	QTY / FRAME	SOLD
3	741322	HEADSET CAP	FSA HEADSET CAP (INCLUDE ON HEADSET)	-	1	AS A SET
4	741323	SEATPOST	CARBON AERO SEATPOST	-	1	PER PIECE
5	741324	BATTERY HOLDER AND BOLT SET	DI2 BATTERY HOLDER	-	1	AS A SET
13			BOLT M5x0.8, L12mm, SBHCS	-	2	
14			WASHER M5	-	2	
6	741325	BB COVER AND BOLT SET	BOTTOM BRACKET COVER	-	1	AS A SET
15			BOLT M3x0.5, L10mm, FCHS	-	1	
7	741326	FD MOUNT AND BOLT SET	FD MOUNT	-	1	AS A SET
12			BOLT M4x0.7, L10mm, FHCS	-	2	
8	741327	SEAT POST WEDGE	SEAT POST WEDGE	-	1	AS A SET
10			BOLT M3x0.5, L8mm, Hex Socket Flat Pt	-	1	
11			BOLT M8x1.25, L810mm, Hex Socket Flat Pt	6	1	
9	741328	ROUND POST ADAPTER	ROUND POST ADAPTER	-	1	PER PIECE
16	738268	UDH	UNIVERSAL DERAILLEUR HANGER	25	1	PER PIECE
17	741329	REAR THRU AXLE	M12x1.0, L168, T13mm, HEX6	10-16	1	PER PIECE
n/a	741330	FRONT THRU AXLE	M12x1.5, L120, T13mm, HEX6	10-16	1	PER PIECE
n/a	741331	BOTTLE BOLT	BOLT M5x12mm	-	4	PER 4 PIECES

HELIOS A CABLE ROUTING

HELIOS A0 AXS

LEGEND

- Front Brake Hose
- Rear Brake Hose



HELIOS A9,A8,A7

LEGEND

- Front Brake Hose
- Rear Brake Hose
- FD Cable
- RD Cable

D12
BATTERY

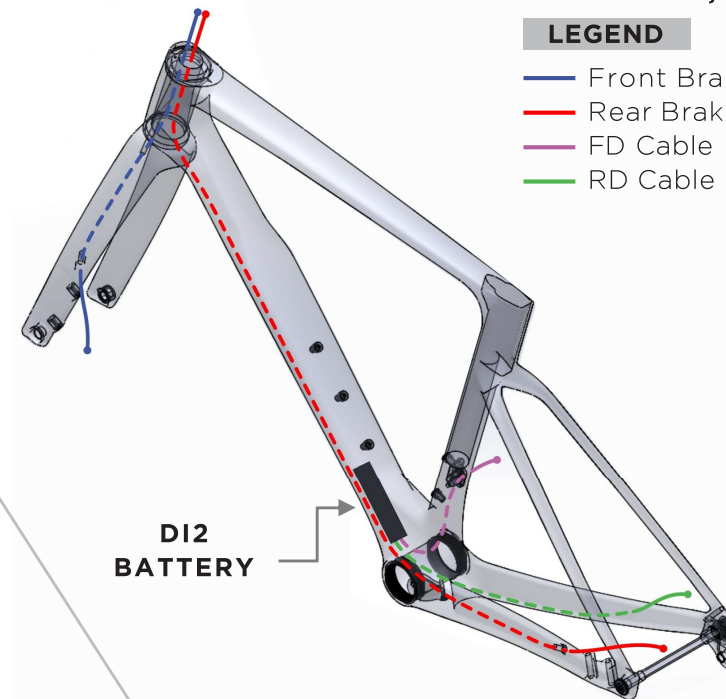

HELIOS A GROUPSET PARTS

COMPONENT	HELIOS A7 DI2	HELIOS A8 DI2	HELIOS A8 DI2 PM	HELIOS A9 DI2	HELIOS A9 DI2 PM	HELIOS A0 AXS
Battery	BT-DN300					SRAM POWERPACK
Electric Wire	EW-SD300-I 350mm					-
	EW-SD300-I 1000mm					
Front Derailleur	FD-R7150	FD-R8150		FD-R9250		SRAM RED ETAP AXS E1
Rear Derailleur	RD-R7150	RD-R8150		RD-R9250		SRAM RED ETAP AXS E1
Brifter	ST-R7170	ST-R8170		ST-R9270		SRAM RED AXS E1
Brake	BR-R7170	BR-R8170		BR-R9270		SRAM RED AXS E1
Cassette	CS-R7101	CS-R8101		CS-R9200		XG-1290 RED
Rotor	RT-CL700	RT-CL800		RT-CL900		RT-PLN-X-A1
Chainwheel	FC-R7100	FC-R8100	FC-R8100-P	FC-R9200	FC-R9200-P	SRAM RED AXS E1
Charging cable	EW-EC300 1500mm					EP-EAC-PP-A1

For further reference, please access the groupset owner's manual by scanning the QR code below.



SHIMANO DI2
MANUAL



SRAM AXS
MANUAL

HELIOS A

SEATPOST CUTTING INSTRUCTION

NOTE

It is essential that Helios seatpost have a 45 degree chamfer cut on the rear trailing edge of the seatpost, without this chamfer may result in damage to the frame. If trimming is required after fitting, the following method is recommended

- Carefully measure before trimming the seatpost
- Use seatpost Cutting Guide sticker as your cutting guidance
- Seatpost Cutting Guide sticker should be attached from rear side of seatpost
- Use a blade designed specifically for cutting carbon composite materials or a fine tooth blade with greater than 32 teeth per inch
- Carefully proceed to cut the seatpost
- Carefully sand the end, use fine grit sandpaper to carefully remove an fraying or burring from the cut end.
- Applying carbon assembly compound before return to the frame.

WARNING

If trimming is required, final length should allow for a **minimum 60mm** of seatpost remaining in the frame. Failure to meet this requirement, may result in damage to the frame not covered by warranty policy, or serious injury to rider.

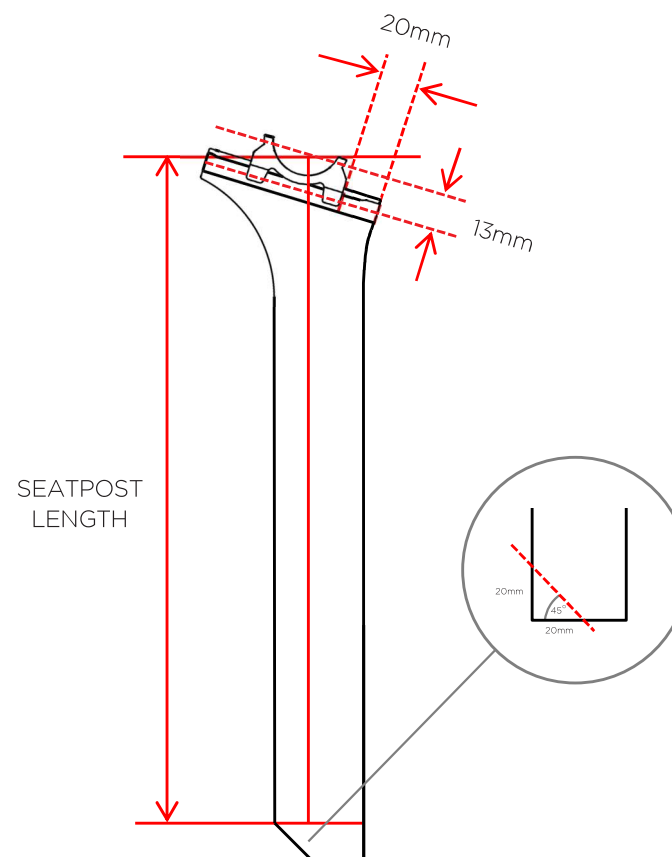

HELIOS A

SEATPOST CUTTING INSTRUCTION

RECOMMENDED SEATPOST LENGTH

SIZE	RIDER HEIGHT (CM)	SEATPOST LENGTH (MM)	DISTANCE FROM BOTTOM LINE (MM)	NOTE
XXXS	143-146	253	121.5	CUTTING IS REQUIRED
	147-149	274	100.5	
	150-153	290	84.5	
XXS	150-156	278	96.5	
	157-160	315	59.5	
XS	157-163	278	96.5	
	164-167	315	59.5	
S	164-174	305	69.5	
M	171-181	335	39.5	
L	178-188	354.5	20	
XL	185-195	354.5	20	NO CUTTING REQUIRED, AS THE 20MM SECTION IS DESIGNATED FOR THE BOTTOM CHAMFER

You will receive a seatpost cutting guide as shown in the image below as part of the Helios A purchase package. Please align the section marked with a red dot according to the recommended seatpost length provided, or alternatively, position it based on the distance from the bottom of the seatpost as indicated in the reference table. Carefully cut the Helios seatpost along the line marked on the seatpost cutting guide.

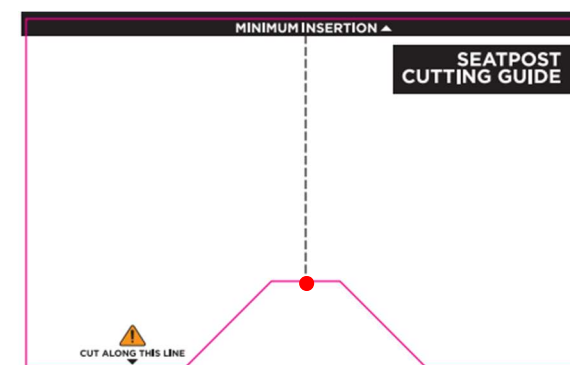

HELIOS A

SEATPOST CUTTING INSTRUCTION

EXAMPLE

Framesize (M)

Seatpost Length Recommended for Size M:
335mm

Cutting Distance Size M (X Length): 39.5
mm

Place the red dot exactly 335 mm vertically
downward from the center of the saddle
rail, or 39.5 mm horizontally upward from
the bottom section of the seatpost.

Ensure that the measurement matches the
recommended seatpost length before
proceeding and cut the seatpost carefully
along the indicated line.

For a clearer visual reference, please refer to
the image on the right.

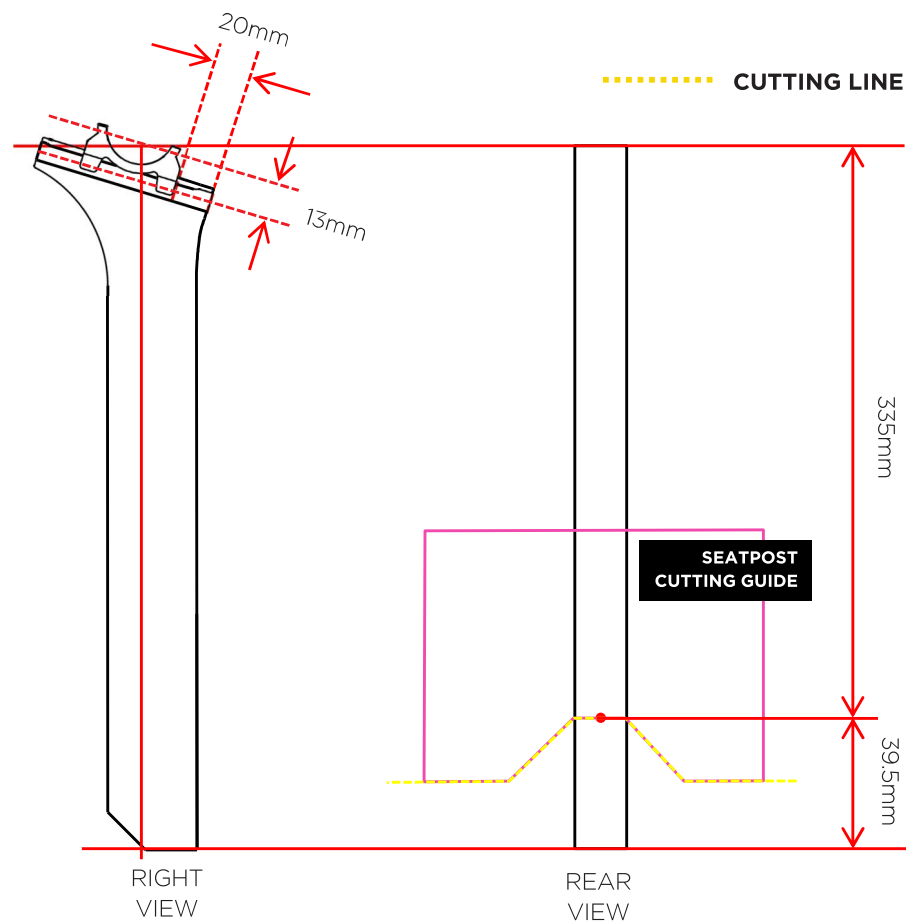

HELIOS A

REGULAR INSPECTION

REGURAL INSPECTIONS BEFORE RIDING THE BICYCLE

Before riding the bicycle, check the following items. If any problems are found, consult your place of purchase or a distributor.

☐

Does the drive train perform gear shifting smoothly?

☐

Are the components securely installed to the frame/ handlebar/ stem, etc.?

☐

Is there sufficient charge remaining in the battery?

☐

Is there any looseness or damage in the component parts?

☐

Do any abnormal noises occur while riding?

AVOID

Avoid wearing clothing that may get caught in a chain or wheel, as this may cause an accident.

HELIOS A

HOW TO CLEAN THE BIKE

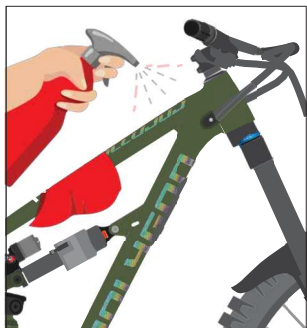

1

Use a bike wash or wet cloth to clean up every part of your bike. Preferably using a specific cleaner for the bike

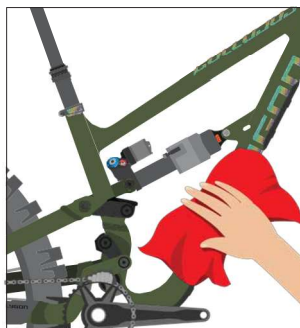

2

Wipe the bike immediately until it's dry. Do not leave it in wet conditions for a long time.



3

Clean up the drivetrain with a clean and dry cloth.

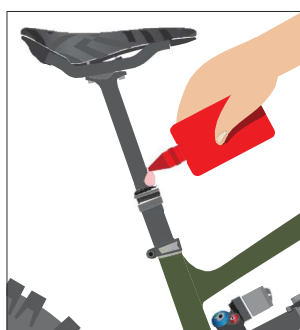

4

Check and lubricate every component if needed, especially 2 or more components that rub against each other, such as the seat post, bottom bracket, hub, pivot frame suspension, ect

NOTE

- Use the right bike wash to make sure your every bike component and frame is safe.
- Avoid washing the bike using high - pressure water
- It is highly recommended to use specific lubricants for bicycle parts, not with engine vehicles or other oil since it might lead to component performance reduction
- It is recommended to use a bike cleaner rather than detergent, solvent like acetone, and thinner to clean the bike parts.

HELIOS A

HOW TO CLEAN THE BIKE'S CHAIN

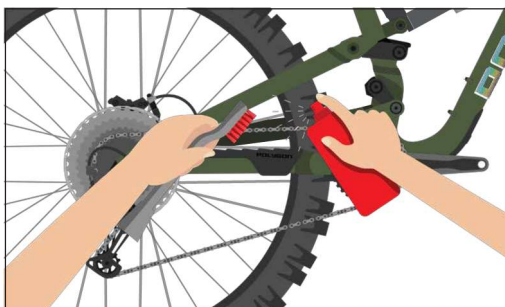

1

Use a bike chain cleaner and gently brush it.



2

Wipe with a clean and dry cloth, and let it dry for minutes.

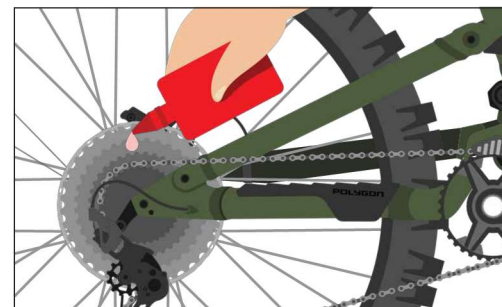

3

Lube the chain regularly

POLYGON

OWNER MANUAL